

CREATION GUIDE

Your guide to beautiful
statement pieces



THE START

“If you are an architect and you have access to the only stylus in the world that can create these kinds of objects, you want to make your moment while you can.”

- Darren Baldwin, President of Pikus



YOUR GO TO

RESOURCE LIST



Review Our Materials

We only use the best materials on the market. Check our material spec sheets for more information and our color guide for available options.

Visit Our Website

Need some inspiration? Visit pikus3d.com. We're here to give you a new method for imagining what concrete can be.

Send Us An Email

Looking to start a new project or request a sample? Email us at create@pikus3d.com to get the conversation going.

Follow us on social media

We frequently update our social media platforms to answer FAQs and provide project inspiration to architects and designers @[Pikus3d](#).

5-STEP

PROCESS

1

Start Dreaming

Every project starts with an idea. We are driven to create with you so that you can wow the world. Send us your sketches or CAD file.



2

Design Collaboration

Our design team iterates with you and ensures the final iteration is printable.



3

Engineering

If needed, engineering professionals make recommendations and the design is adjusted to meet requirements.

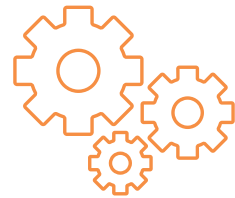

4

Printing

Your design is sliced and printed. Turning your wildest dreams into reality.

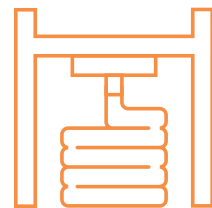

5

Installation

Your statement piece is shipped to the installation site. Professional installers will carefully move your design into place with recommended installation instructions via QR code.





START DREAMING

Envisioning the possibilities for your project.

AT A GLANCE

The ideation phase is designed to promote creativity and to push the boundaries of what is possible.

SOLUTIONS

You no longer have to fit your ideas into the confines of traditional formwork. We've removed these boundaries so that your imagination can steer every decision. Through close collaboration, our team will work with you to find solutions that fit your needs.

GENERAL COST ANALYSIS

Once the design is solidified and the project feasibility is established, an initial quote will be generated. You will receive a quote after the final design review.



DETERMINE DESIGN CRITERIA

After your original design sketch is created and sent to our design team, our specialists will suggest adjustments for successful printability. Extra design specifications will be discussed at this time. These may include:



LED Lighting



Water



Fire

DESIGN VARIATIONS:

1. YOUR MODEL

The type of model originally presented will affect project time. CAD files are quickest and the preferred file. We work with SketchUp, Rhino, Revit, or simply a drawing if needed.

2. DIMENSIONS

Please make sure that all models have the correct dimensions for your project. Our statement pieces require dimensions for length, depth, and height.

3. COMPLEXITY & QUANTITY

Project completion time may be dependent upon the complexity of your design and the quantity of your order.



DESIGN COLLABORATION

Perfect the design and receive your final quote.

AT A GLANCE

Your design is finalized and a final quote is provided for your project.

REVIEW THE DESIGN

The design will be reviewed and approved. In this step we ensure all design specifications are being met according to your needs.

A FINALIZED QUOTE

The completed design will be quoted. All design aspects will be considered in the final quote.

VR PROTOTYPE

Some clients will require a more in-depth view of their projects. Final 3D models can be viewed in VR upon request





ENGINEERING

Validating your design.

AT A GLANCE

This process ensures that your design can be printed to specifications and all design criteria can be met.

THE VALIDATION PROCESS

A formal engineering evaluation will be conducted to ensure all standards are met and the need for reinforcements are evaluated. Safety, durability, attachments, and other needs are also evaluated.

DESIGN DOCUMENTATION WILL BE REFERENCED
THROUGHOUT YOUR PROJECT



1

Project Specifications

Project material, finishes, and reinforcements are considered.

2

Testing and Evaluation

A determination of further engineering requirements is considered.

3

Digital Assets*

A custom, near photo-realistic, rendering with capability of being viewed in VR will be included with your project.

*ALL DIGITAL ASSETS ARE THE PROPERTY OF PIKUS
UNLESS OTHERWISE SPECIFIED

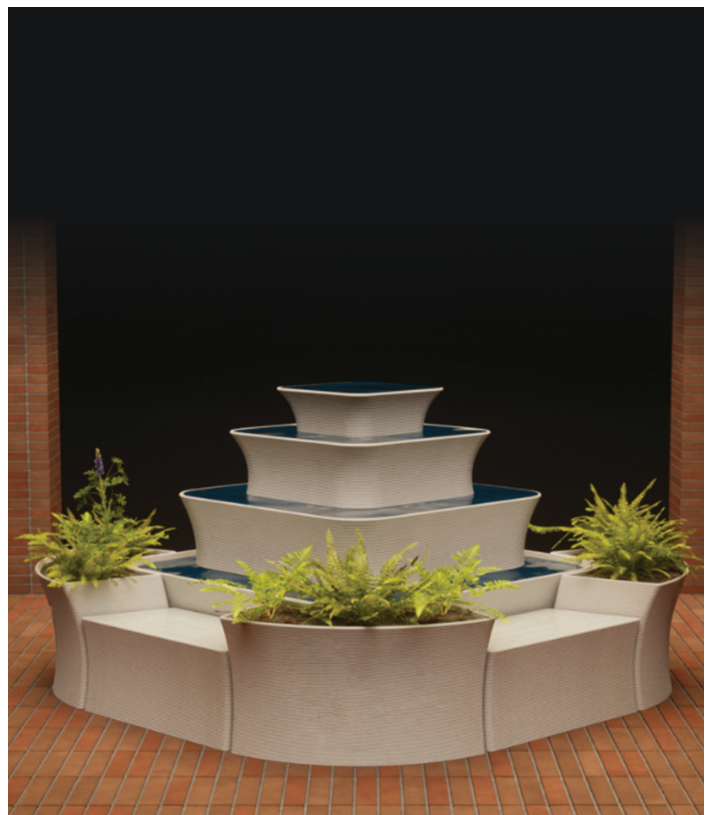



PRINTING

Executing your design.

AT A GLANCE

Your design is sent to our manufacturing team and the printing process begins.

THE MATERIAL

Your design will be fabricated using Sika mortar mix. We only use the best material on the market, ensuring a long-lasting statement piece.

PRINTING FACILITY

Your design is printed in a climate-controlled environment which allows for precise prints without weather delay. Our rapid printer allows most designs to be completed in under an hour. Once complete, the curing process begins.

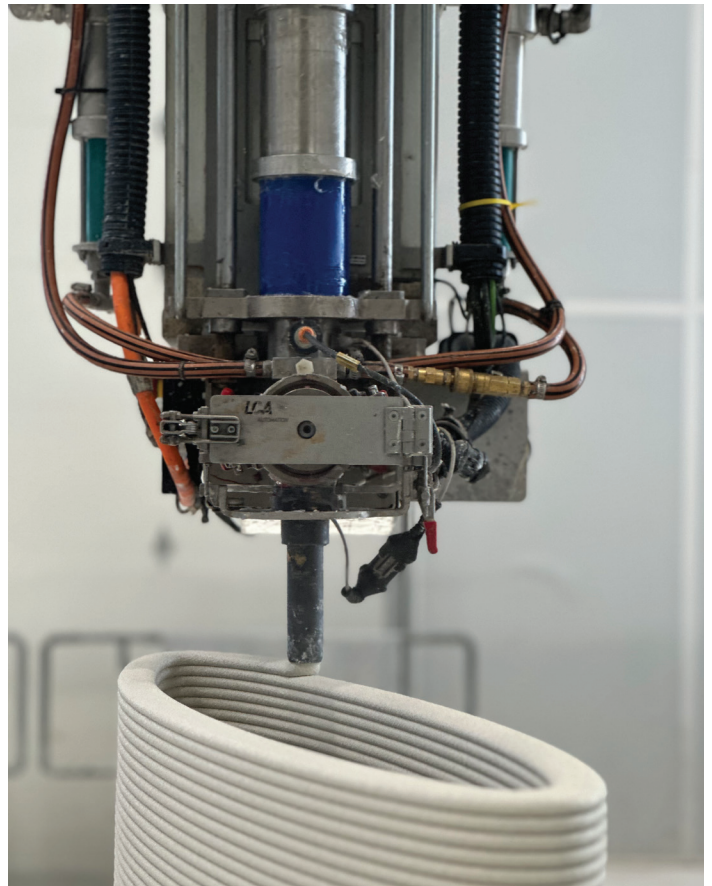

RESOURCES FOR PRINTING:

1. Tour Our Facility

Interested in taking a virtual tour of our facility?
Contact us at create@pikus3d.com.

2. Visit Our Website and Social Media

Our website will have resources to guide you through the printing process. Our social media profiles are also frequently updated to answer your questions.

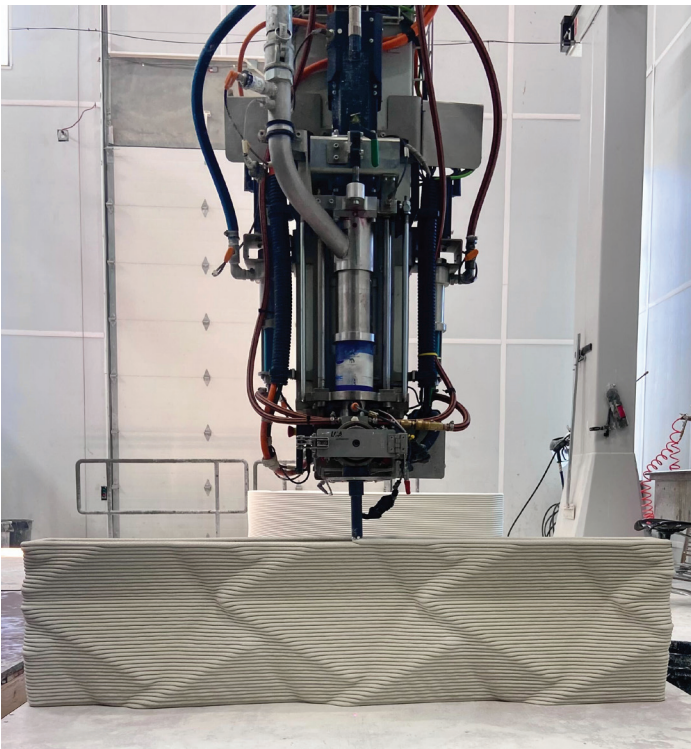



INSTALLATION

Ensuring the highest quality installation process.

AT A GLANCE

Your statement piece is crated, shipped, and installed (via partners) at location.

POST-PRINT

Once your design is cured, it will be inspected for flaws. After completing post-print procedures, your statement piece is prepped for shipping.



CRATING & SHIPPING

Having fully cured, your statement piece is expertly packed in custom crates and shipped to your location.



INSTALLATION

Once your statement piece has reach the installation site, a team of experienced installers will carefully move it into place with detailed instructions via QR Code.

For more information on our installation partners, please contact create@pikus3d.com.



MAKE A STATEMENT



Darren Baldwin
President | Pikus
darren@pikus3d.com
pikus3d.com

9573 South 6400 West
West Jordan, UT 84081
(385) 308-8324